

Tools Required

- Phillips head screw driver
- ½inch or 13mm wrench



Approximate Assembly Time

20 minutes

Broil King®
KEG

READ ME FIRST
UNPACKING & ASSEMBLY INSTRUCTIONS
911770 / 4000 Series



The only tools you will need:

- Phillips head screw driver
- ½inch or 13mm wrench

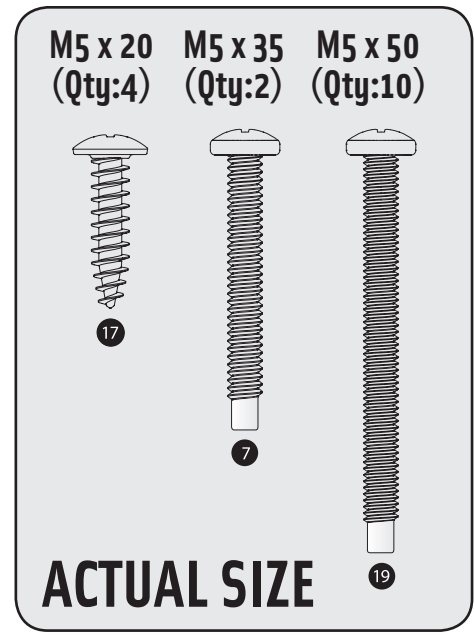
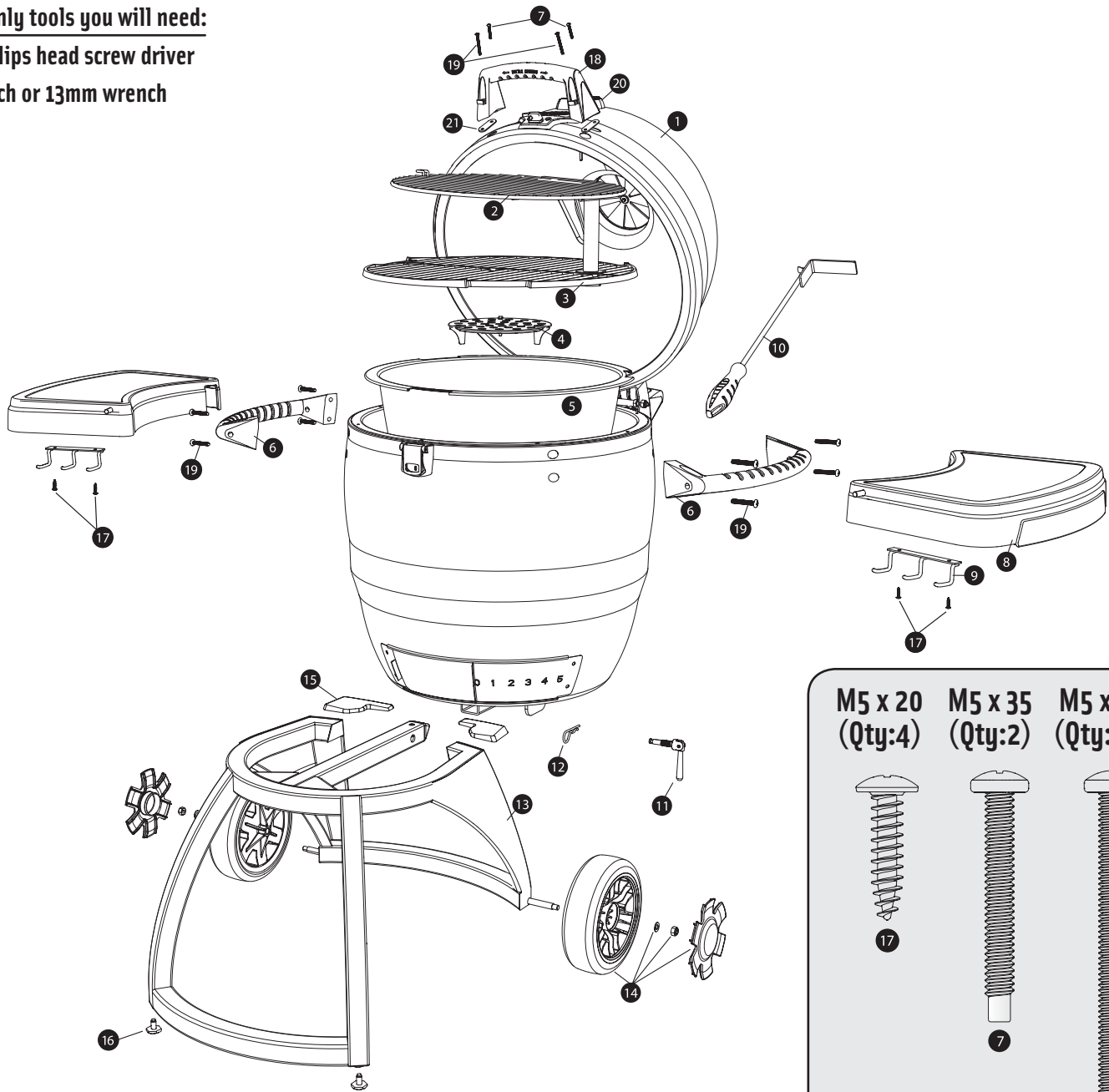

LINE ITEM	QTY	PART NAME	LINE ITEM	QTY	PART NAME
1	1	Grill Body	12	1	Hitch Pin Safety Clip
2	1	Top Cooking Grate	13	1	Stand
3	1	Main Cooking Grate	14	2	Wheel Assembly
4	1	Charcoal Grate	15	2	Grill Wedges
5	1	Fire Bowl	16	2	Leveling Feet
6	2	Side Handle	17	4	Tool Holder Screws - M5 x 20
7	2	Handle Screws - M5 x 35	18	1	Lid Handle
8	2	Side Trays	19	10	Handle Screws - M5 x 50
9	2	Tool Holder	20	1	Temperature Gauge
10	1	Multi-Tool	21	2	Handle Gasket
11	1	Hitch Pin			

Proper assembly of your new BROIL KING® KEG will only require a Phillips head screw driver, a ½ inch or 13mm wrench and a buddy (for lifting). Follow the steps outlined below and it should take approximately 20 minutes to complete. Refer to illustration on page 2 for part(s) identification and placement positions.

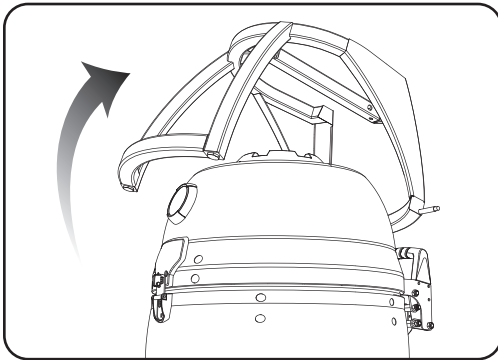

STEP 1: Remove the Keg's stand.

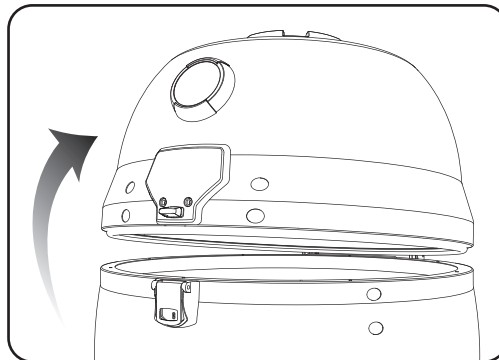

STEP 2: Unlock clasp and open the Keg's lid. Remove and unpack all contents and check against parts inventory list.

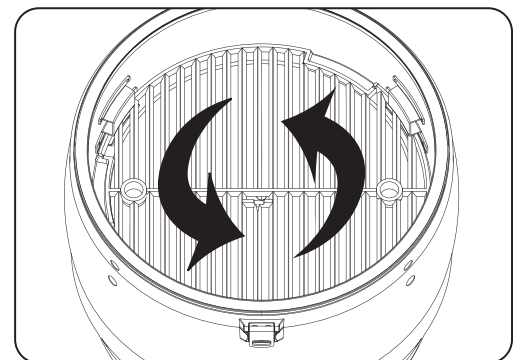

STEP 3: Rotate the cast iron grate out of the locked position, remove and set aside.

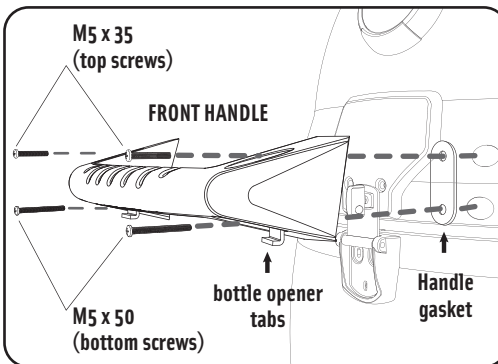

STEP 4: Attach front handle with Phillips head screwdriver. M5x50 screws go in the bottom holes with the bottle opener tabs. M5x35 screws go in the top holes. Silicone gaskets install behind handle (two places).

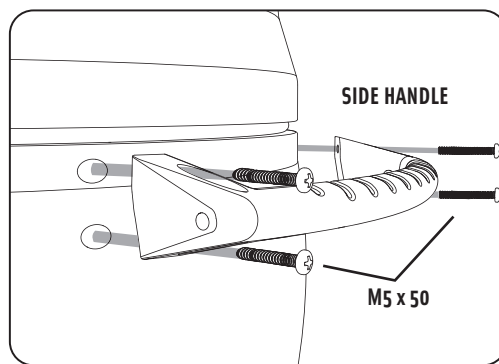

STEP 5: Attach side handles (2) using 4 (M5 x 50) screws. (Use Phillips head screwdriver)

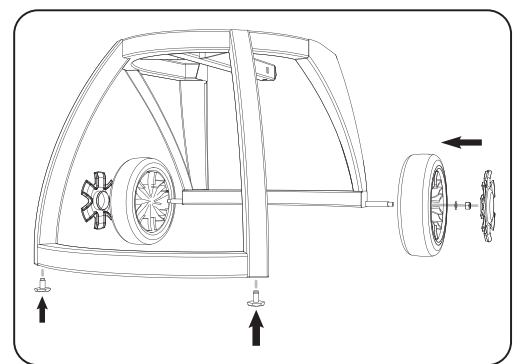

STEP 6: Attach both wheels to the axle posts on the stand in the following order: wheel, washer nut and hub cap. Use ½ inch or 13mm wrench. Then screw in leveling feet to stand.

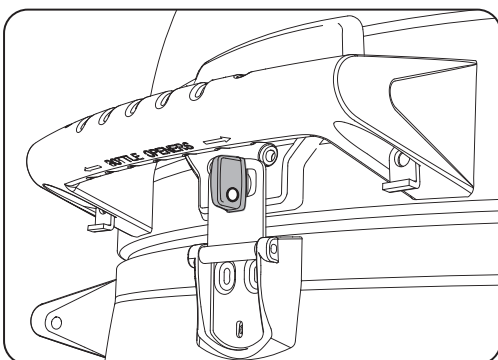

STEP 7: With everything out of the grill, relock clasp on the Keg's lid.

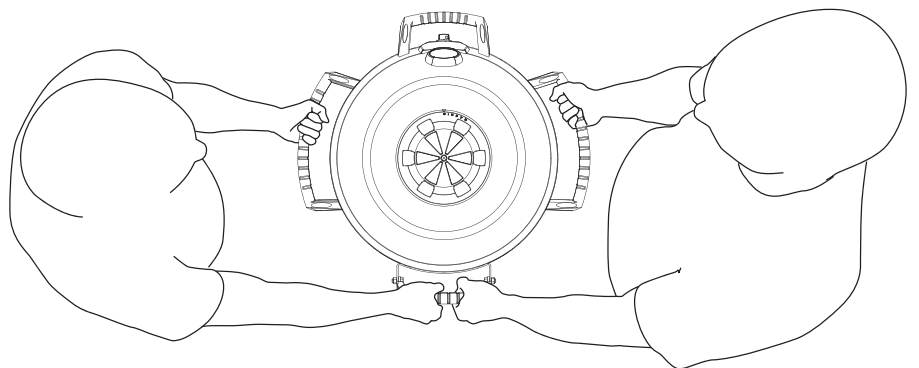

STEP 8: With one person on each side of the BROIL KING® KEG, lift out of the box gripping side and back handles only. Do not use the front handle to lift the entire grill weight.

BROIL KING® KEG ASSEMBLY INSTRUCTIONS (CONTINUED)

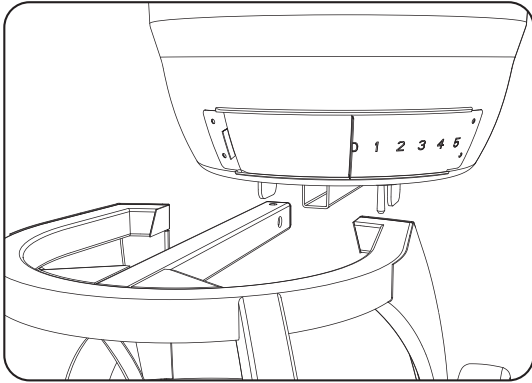

STEP 9: Holding stand in a stationary position on a firm surface and Grill upright, insert hitch post on stand into square female receiver slot (as illustrated). Slide completely forward until hitch pin holes are aligned.

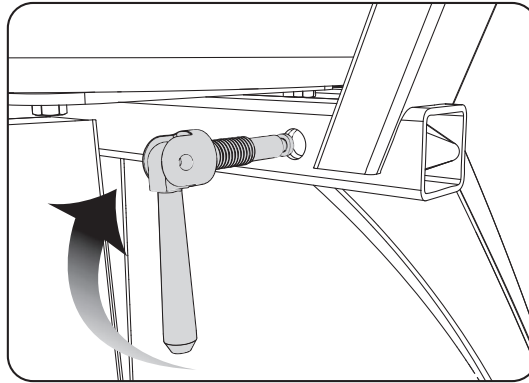

STEP 10: It is important to install the threaded hitch pin securely between the stand and grill. Turn clockwise to tighten. Remember always use the safety clip.

(Note: If your hitch pin does not fully tighten, install the pin from the opposite side.)

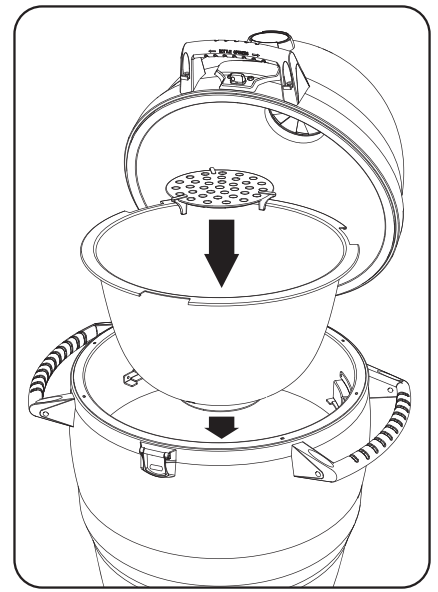

STEP 11a: Now that the grill is securely on the stand, open the lid and put the following parts in place starting at the bottom of the BROIL KING® KEG:

- Fire bowl
- Charcoal grate

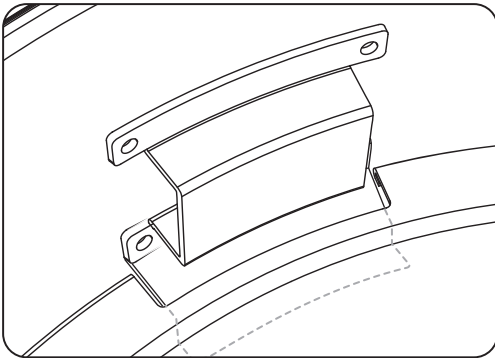

STEP 11b: Align the notches in the fire bowl with the fire bowl supports inside the grill (as illustrated).

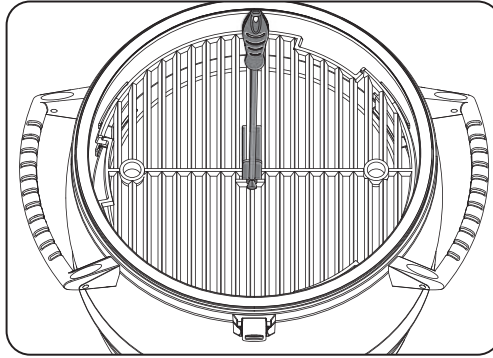

STEP 11c: Use the Multi-Tool to lift and install cast iron cooking grate by inserting it into the center slot as shown.

- Cast iron cooking grate can be used in either the upper or lower position.

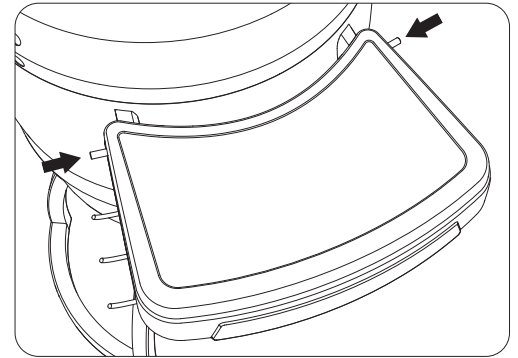

STEP 12: Install Tool Holders (2) on Side Trays using 4 (M5x20) screws. Depress buttons and attach Side Trays over both side handles. They "click" when locked into position.

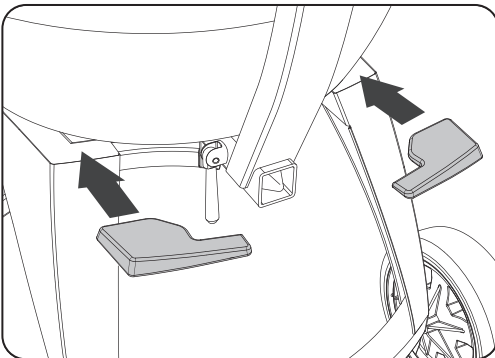

STEP 13: Insert Grill Wedges one at a time between the Grill Body and Grill Stand corners by firmly pushing forward until they snap into place.

(It may be necessary to loosen hitch pin in order to fit Wedges. Remember to tighten back.)

Broil King® KEG

ONWARD MANUFACTURING COMPANY LTD.
585 Kumpf Drive • Waterloo, Ontario, Canada • N2V 1K3
info@omcbbq.com • Phone: 519.885.4540 • Fax: 519.885.1390
North America Customer Service: 1.800.265.2150